

MEGAMAN® RENZO Emergency Option

FCL53600v0-em/hp, FCL71000v0-em/hp, FCL71100v0-em/hp



Instruction Manual | Bedienungsanleitung | Manual de instrucciones | Manuale d'istruzioni | Manuel d'instructions | Handleiding | Návod k použití

⚠️

📖 🧑‍🔧 📱 + 🧤 ⚡️ ❌ 🔧 H05RN-F/3G1.0 H07RN-F/3G1.5 → IP44 🗣️ 📺 MEGAMAN® www.megaman.cz/user-guide

🔧

A1 3 PCS	A2 3 PCS	A3 3 PCS	A4 3 PCS	A5 2 PCS	A6 Ni-Cd 2000mAh 7.2V LA11104(optional)
-----------------	-----------------	-----------------	-----------------	-----------------	---

Caution – Risk of Electric Shock! Vorsicht - GEFAHR EINES STROMSCHLAGS! ATENCIÓN - RIESGO DE DESCARGA ELÉCTRICA! Attenzione - RISCHIO DI SCOSSA ELETTRICA!
ATTENTION - RISQUE DE CHOC ÉLECTRIQUE! Voorzichtig - GEVAAR VOOR EEN ELEKTRISCHE SCHOK! POZOR! - Riziko úrazu elektrickým proudem.
 The light source contained in this luminaire shall only be replaced by the manufacturer or his service agent or a similar qualified person.
 Das in dieser Leuchte enthaltene Leuchtmittel darf nur durch den Hersteller, seinen Kundendienst oder entsprechend qualifiziertes Fachpersonal ausgetauscht werden.
 La fuente de iluminación de esta luminaria solo debe ser sustituida por el fabricante o su agente de servicio, o en su caso, por personal cualificado.
 La sorgente luminosa contenuta in questo apparecchio deve essere sostituita esclusivamente dal produttore, dal suo rappresentante o da una persona similmente qualificata.
 La source lumineuse contenue dans ce luminaire ne doit être remplacée que par le fabricant ou son agent de maintenance ou une personne de qualification équivalente.
 De lichtbron in deze lamp mag alleen worden vervangen door de fabrikant, zijn serviceagent of een vergelijkbaar gekwalificeerd persoon.
 Zdroj světla v tomto svítidle smí být vyměněn pouze elektrikářem, nebo servisním agentem výrobce.

	P	I	λ	
FCL53600v0-em/hp	16.5W	102mA	>0.7	Ø340 x H130
FCL71000v0-em/hp	13.5W	84mA	>0.7	Ø280 x H130
FCL71100v0-em/hp	21.5W	134mA	>0.7	Ø390 x H130

220-240V~ 50/60 Hz Ta -5°C ~ +40°C IP44

Instruction Manual | Bedienungsanleitung | Manual de instrucciones | Manuale d'istruzioni | Manuel d'instructions | Handleiding | Návod k použití

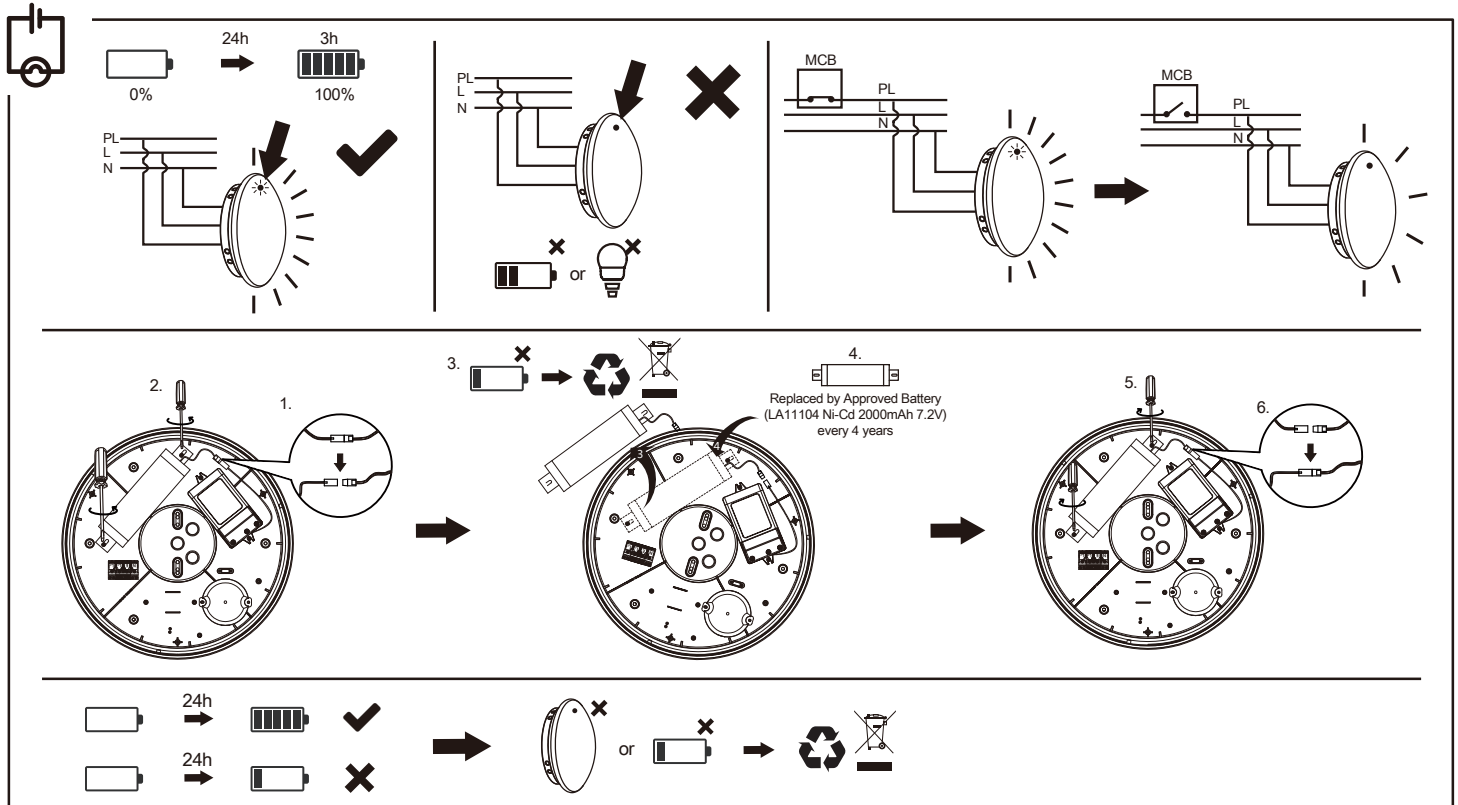

EMERGENCY LUMINAIRE TEST RECORD

INSTALLATION ENGINEERS TEL

LUMINAIRE TYPE IDENT/SERIAL No

LOCATION INSTALLATION DATE

MONTH	TEST TYPE	FIRST YEAR		SECOND YEAR		THIRD YEAR		FOURTH YEAR		FIFTH YEAR	
		SIGN	DATE	SIGN	DATE	SIGN	DATE	SIGN	DATE	SIGN	DATE
1	FUNCTIONAL										
2	FUNCTIONAL										
3	FUNCTIONAL										
4	FUNCTIONAL										
5	FUNCTIONAL										
6	1 HOUR										
7	FUNCTIONAL										
8	FUNCTIONAL										
9	FUNCTIONAL										
10	FUNCTIONAL										
11	FUNCTIONAL										
12	1 HOUR										
13	FULL DURATION										

DAILY: check charge indicators are lit maintained/combined lamps illuminate; any faults are recorded
 MONTHLY: in addition to the daily check - a functional test of at least 3 minutes duration to confirm lamp is working on battery power by simulating a mains failure.
 SIX MONTHLY: in addition to the daily check - a functional test of at least one hour to confirm lamp is working on battery power by simulating a mains failure.
 ANNUALLY: in addition to the daily check - a functional test of rated duration to confirm full operation to specification by simulating a mains failure.
 A copy of this report must accompany any fitting returned to the manufacturer for any reason.